

- PENDANTS: eleven
- CANOPY: white powder-coated round canopy  
600mm (24") in diameter
- LAMPING: 2.3W LED
- LENGTH OF COAX: determined by client 30500 (100') standard maximum
- INSTALLATION: jack connected (pendant lengths set during production)
- MATERIALS: blown glass, braided metal coaxial cable, electrical components, white powder coated canopy
- WEIGHT: 47kg - 61kg (103 - 134lb) complete, individual pendants:  
standard 2-4 kg (4-8 lbs) | oversize 4-5 kg (8-11 lbs)
- TRANSFORMERS: integral

#### DESCRIPTION

73.8 is a random configuration of eight 73 pendants hung from a round canopy. The drop lengths of the pendants are randomized between a client specified range of heights to variously cluster and scatter. The result is an ambient chandelier or field of light.

The 73 is formed by blowing liquid glass into a folded and highly heat-resistant ceramic fabric vessel. The resulting shape has a formal and textural expression intuitively associated with fabric, which becomes permanent and rigid as it cools. Each 73 is completely unique in proportion, size and shape.

#### NOTES

- + Purchase replacement lamps online at [www.bocci.ca/lamps](http://www.bocci.ca/lamps)
- + Note: As an alternative to a built-in transformer, Bocci recommends mounting transformers remotely in an easily accessible and hidden location for ease of long-term maintenance.

US patent # US 29/474,814  
Worldwide patents issued and pending.  
Made in Vancouver, Canada

Vancouver  
[sales@bocci.ca](mailto:sales@bocci.ca)  
[www.bocci.ca](http://www.bocci.ca)

Berlin  
[europa@bocci.ca](mailto:europa@bocci.ca)  
[www.bocci.ca](http://www.bocci.ca)

~47 - 61kg (103 - 134lb)

ROUND

# 73.11

Design by Omer Arbel  
PRODUCT SPECIFICATION

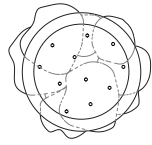

470 (18.5')

600 (24')

1

Measure and mark the chandelier canopy position on the ceiling.

plywood dimensions

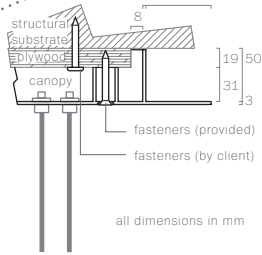

2

Note: The client is responsible for providing a robust 3/4" (19mm) plywood backing or wood blocking to securely anchor to the structural substrate.

Connections from the plywood to the structural substrate are the client's responsibility. Measure the plywood so that it fits within the canopy side walls (refer to detail above).

Anchor the plywood backing to the structural ceiling substrate.

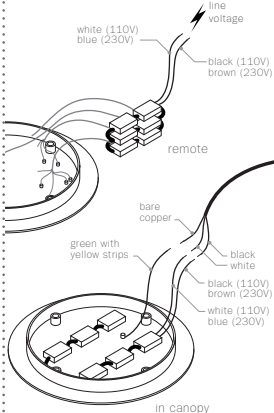

3

Connect LED drivers inside the canopy to line voltage. 110 V or 230 V.

For 110 V, connect black wire to the black wire and white wire to the white wire.

For 230 V, connect black wire to the brown wire and white wire to the blue wire.

For the ground connection, connect the green wire with yellow stripe to the bare copper wire or green wire in the junction box.

Note: As an option, Bocci recommends mounting LED drivers remotely in a close, accessible and hidden location for ease of long term maintenance. Installation to be done by certified personnel to ensure compliance with the code.

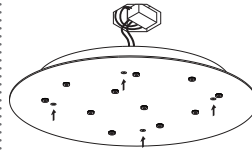

4

Anchor canopy into the plywood backing using the fasteners provided.

If your chandelier has multiple canopies, mount all canopies, one by one, per the previous steps.

If your chandelier has only one canopy, proceed to step 5.

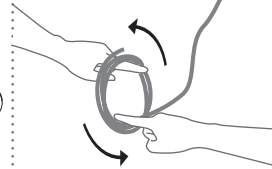

5

Remove the twist ties from the coaxial cable. Hold the roll vertically and insert your index fingers from opposite sides. Rotate your fingers in a spool like manner around each other to unroll the coaxial cable. Use patience; allow the cable to uncoil completely to avoid kinks.

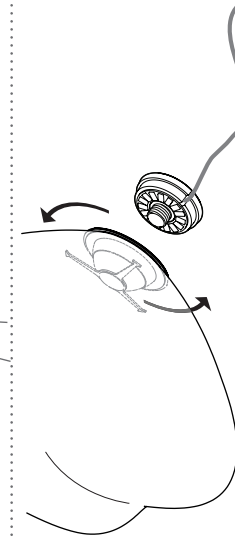

6

Each pendant terminates in a "headphone jack" type connector, which plugs into a receiving receptacle in the canopy. Clients are encouraged to compose their own pendant configuration on site, thus creating a truly unique chandelier. After plugging in each pendant, turn the threaded sheathing into place by hand ensuring that it is adequately tightened. Tools are not required.

Bocci 24.3 ring-shaped LED lamp included.

To attach the glass pendant to the cap simply rotate it on. Note: Rotate the glass - not the cap, otherwise the coax will twist.

Purchase replacement LEDs online at [www.bocci.ca/lamps](http://www.bocci.ca/lamps)

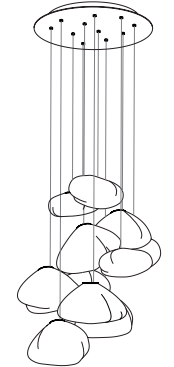

7

Clean fingerprints from glass surfaces.

Turn fixture on.

\*

For additional assistance:

Vancouver  
info@bocci.ca  
www.bocci.ca

Berlin  
europe@bocci.ca  
www.bocci.ca

Worldwide patents issued and pending.

Made in Vancouver, Canada

ROUND

73.11

Design by Omer Arbel  
INSTALLATION INSTRUCTIONS