

1320 (52')

1190 (46.8')

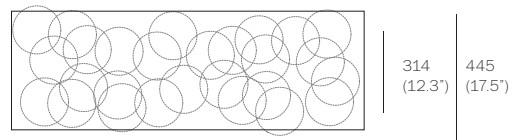

approx 81 kg (178 lb)

- PENDANTS: twenty-eight
- CANOPY: white powder-coated square canopy
1320mm (52") x 445mm (17.5") and 53 (2") deep
- LAMPING: 20w xenon or 1.8w LED
- DIMMING: xenon: dimmable - use electronic, trailing edge dimmer only
LED: dimmable - use electronic low voltage dimmer only
- CABLE LENGTH: Up to 9000mm (30') standard. Custom lengths available
- INSTALLATION: jack-connected (lengths set during production)
- MATERIALS: blown glass, flexible copper tubing, electrical components,
copper hardware, white powder coated brushed nickle canopy
- WEIGHT: approximately 81 kg (178 lb)
- TRANSFORMERS: integral

DESCRIPTION

28.28c is a random configuration of twenty-eight 28 pendants hung from a rectangular canopy. The pendants are designed to hang in a random configuration at times clustering together and others trailing off. The result is an ambient installation or field of light.

28 is an exploration of specificity in manufacturing. Instead of designing form, the intent was to design a system of making that yields form. Individual 28 pendants result from a complex glass blowing technique whereby air pressure is intermittently introduced into and then removed from a glass matrix which is intermittently heated and then rapidly cooled. The result is a distorted spherical shape with a composed collection of imploded inner shapes, one of which acts as ashade for a low voltage (12V, 20W) xenon light source.

The 28 copper series provides a different compositional reading that results from shaping the copper tubing during installation. Pendants can be angled in any direction to provide a range of sculptural forms. The copper will weather and tarnish, registering the passage of time in its patina.

Standard 28s are made with clear glass exterior spheres and milk white interior lamp holder cavities. 28s are possible with infinite versatility in colour and composition.

NOTES

- + Preset lengths may have a variance of +/- 50mm (2')
- + Requires transformers to be remote mounted.
- + For xenon fixtures, one transformer sent for every 3 pendants
For LED, one driver sent for every 13 pendants.
- + Purchase replacement lamps online at www.bocci.ca/lamps
- + Unless otherwise noted when ordering, all light fixtures will be outfitted to be xenon compatible.

US patent # D687,740 Worldwide patents issued and pending.

Made in Vancouver, Canada

Vancouver Berlin
sales@bocci.ca europa@bocci.ca
www.bocci.ca www.bocci.ca

RECTANGLE
28.28c PRODUCT SPECIFICATION



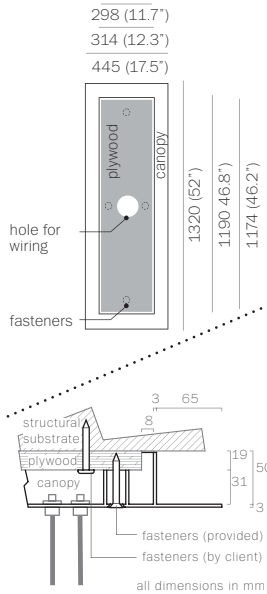

1

Measure and mark the light fixture canopy position on the ceiling.

Note: The client is responsible for providing a robust 3/4" (19mm) plywood backing or wood blocking to securely anchor to the structural substrate.

Connections from the plywood to the structural substrate are the client's responsibility. Measure the plywood so that it fits within the canopy side walls (refer to detail above).

Anchor the plywood backing to the structural ceiling substrate.

Remote mount

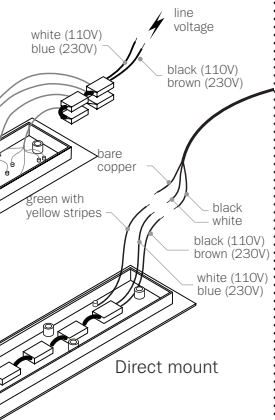

Direct mount



2

Connect transformers inside the canopy to line voltage. 110 V or 230 V depending on transformer.

For 110 V xenon fixtures, connect black wire to the black wire and white wire to the white wire.

For 230 V xenon fixtures, connect black wire to the brown wire and white wire to the blue wire.

For 110 - 230 V LED fixtures, connect black wire to the black wire and white wire to the white wire.

For the ground connection, connect the green wire with yellow stripe to the bare copper wire or green wire in the junction box.

Note: As an option, Bocci recommends mounting transformers remotely in a close by, accessible and hidden location for ease of long term maintenance. Installation to be done by certified personnel to ensure code compliance.



3

Anchor canopy into the plywood backing using the fasteners provided.

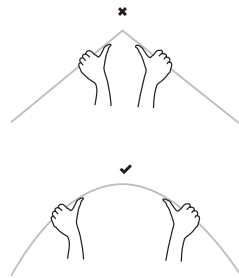

4

Carefully uncoil the copper length bit by bit with both hands to avoid kinking.

Using both hands close together, straighten a small section at a time.

Start on one end and work towards the other in a linear fashion.

Do not hold both ends at once to uncoil.

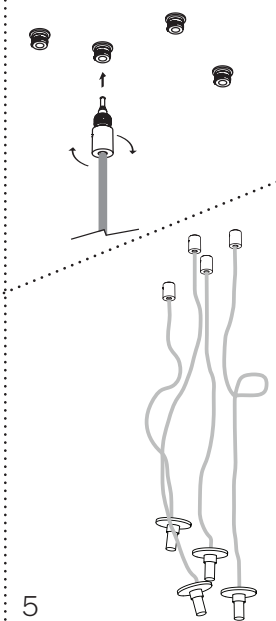

5

Each copper length terminates in a "headphone jack" connector, which plugs into a receptacle in the canopy. After plugging in each length, turn the threaded sheathing into place, wiggling back and forth to ensure that it is adequately tightened.

Compose the copper tubing according to the intended design aesthetic.

Note: optionally, all copper lengths can be swagged to other locations using aircraft cable and hooks screwed to the ceiling. Please see specific swag specifications and instructions for more details.

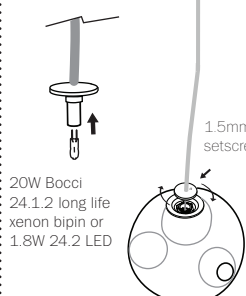

6

Plug the lamp into the socket.

Make final adjustments to shape the copper tubing to your desired composition.

Install 28 pendant by inserting the socket into the opening and then threading the copper cap into the pendant by hand. Do not over tighten. Tighten set screw in cap with included 1.5mm allen key.

Note: Once the pendant is added, it will pull the copper downwards. The pendant will try to hang directly below the canopy as the copper is not rigid enough for long horizontal compositions.

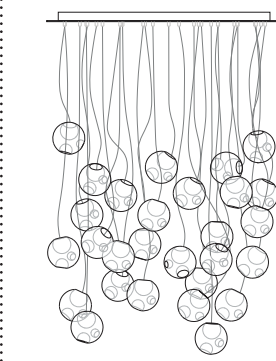

7

Clean fingerprints from glass surfaces.

Turn fixture on.

* Purchase replacement lamps online at www.bocci.ca/lamps

For additional assistance, please contact Bocci:

Vancouver
sales@bocci.ca
www.bocci.ca

Berlin
europe@bocci.ca
www.bocci.ca

Worldwide patents issued and pending.

Made in Vancouver, Canada

RECTANGLE
28.28c

INSTALLATION INSTRUCTIONS



BOCCI